

✪ How to Measure ✪

In order to ensure you order the correct product, you must measure the net opening of a cabinet taking into account any obstruction such as cabinet door hinges and plumbing.

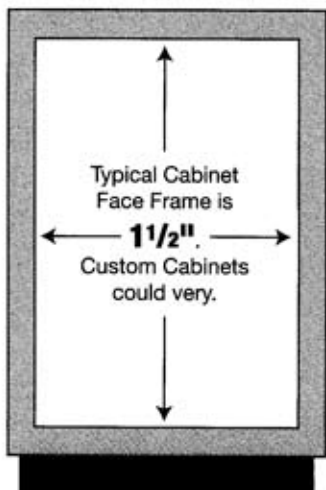

✪ Typical Cabinet ✪

This field is a reference used in the U.S. Cabinet Industry measuring the outside dimension of the cabinet. We have based this cross-reference on 1 1/2" face frame construction cabinets, the most common in the United States. We realize that many cabinet companies construct their cabinets differently and we recommend using this only as a guide. To be sure if a product will fit in your application, please refer to the measuring your cabinets section on this page.

(i.e Base 18" cabinet would have a 15" W opening)

